

PRO-STEEL

Steel Edging and Landscape Products



PS14 - 14 Gauge
10' Lengths

PS10 - 10 Gauge
10' & 16' Lengths

PS3/16 - 7 Gauge
10' & 16' Lengths

PS1/4 - 4 Gauge
10' & 16' Lengths

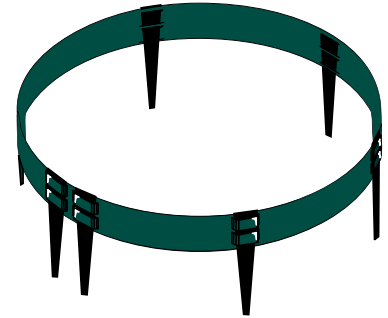

Tree Rings
C14 - 20", 28", 36"
C10 - 36", 60-72"

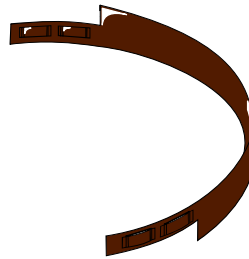

Tree Circle
Sections
20 per Box CS14

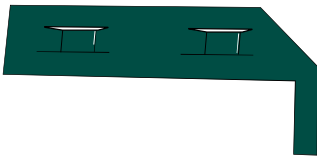

End Pieces
PS End

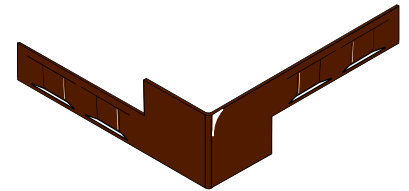

Pre Formed Corners
C90 PS

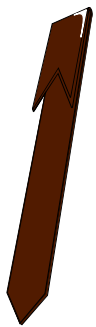

J-Stakes
J-STKS



Stakes
PS-STKS



Poly
Board
U-STKS



T-Post
PSTPOST56



Lodge Pole
PSLodge

5121 Kaltenbrun Road
Fort Worth, TX 76119
1 - 800 - 542 - 4518

www.Pro-Steel.com

CATEGORY	ITEM	QTY	PCS		UNIT WEIGHT	EDGING WEIGHT	STKS EA	STKS	TOTAL	TTL WGT	TRUCK QTY-PCS	TRUCK QTY-PLTS
			PLTS	BNDL				PER PLTS	STKS WGT			
EDGING		FEET	EA	EA	PER FT	LBS	EA	EA	LBS	LBS		
	PS14-10'	3000'	300	10	0.99	2944 #	4	1200	500 #	3444 #	3900	13
	PS14-10' x 6"	2000'	200	10	1.53 #	3055 #	4	1200	500 #	3555 #	2600	13
	PS 10-10'	2100'	210	5	1.43 #	2988 #	4	840	365 #	3353 #	2100	14
	PS10-16'	1600'	100	5	1.49 #	2376 #	6	600	225 #	2601 #	1400	18
	PS10-10' x 6"	2000'	200	5	1.66 #	3311 #	4	800	350 #	3661 #	1470	12
	PS3/16-16'	800'	50	5	2.16 #	1726 #	6	300	208 #	1934 #	950	24
	PS3/16-16' x 6"	800'	50	5	3.54 #	2828 #	6	300	208 #	3036 #	800	15
	PS 1/4-10' 4" w/J-Stakes	600'	60	3	3.4 #	2040 #	3	180	158 #	2176 #		
	PS 1/4-10' 5" w/J-Stakes	600'	60	3	4.2 #	2520 #	3	180	158 #	2656 #		
	PS 1/4-10' 6" w/J-Stakes	600'	60	3	5 #	3000 #	3	180	158 #	3136 #		
	PS 1/4-16' 4" w/J-Stakes	480'	30	3	5.1 #	2448 #	4	120	122 #	2539 #		
	PS 1/4-16' 5" w/J-Stakes	480'	30	3	6.3 #	3024 #	4	120	122 #	3115 #		
	PS 1/4-16' 6" w/J-Stakes	480'	30	3	7.5 #	3600 #	4	120	122 #	3691 #		
CIRCLE SECTIONS												
	CS14-CIRCLE SECTION	EACH			2.45 #		2	.8 #	3.25 #			
	CS14-CIRCLE SECTION	20/BOX			49 #		40	16 #	65 #			
TREE RINGS												
	C14-20"	EACH			5.7 #		2		.8 #	6.5 #		
	C14-28"	EACH			7.8 #		3		1.2 #	9 #		
	C14-36"	EACH			9.9 #		4		1.6 #	11.5 #		
	C10-36"	EACH			15.9 #		4		1.6 #	17.5 #		
	C10-60"	EACH			26.1 #		6		2.4 #	28.5 #		
	C10-72" (2PCS)	EACH			40 #		8		3.5 #	43.5 #		
STAKES												
	PS STAKES	40/BOX			15 #							
	PS STAKES	EACH			.375 #							
	PS J-STAKES	20/BOX			12 #							
	PS J-STAKES	EACH			.60 #							
	PS STAKES 16"	40/BOX			21 #							
	PS STAKES 16"	EACH			.53 #							
	PS U-STAKE	100/BOX			41 #							
	PS U-STAKE	EACH			.4 #							
WOOD												
	LODGE POLE 2" x 8'	300/PALLET				2001 #/PALLET						
Not sold individually	LODGE POLE 2" x 8'	EACH			6.67 #	6.67 #						
T-POST												
	T-POST 5' 6"	200/PALLET				1394 #/PALLET						
Not sold individually	T-POST 5' 6"	EACH			6.88 #	6.97 #						
ACCESSORIES												
	CORNERS INSIDE POCKETS 14GA	20/BOX			38 #	38 #	40		16 #			
	CORNERS INSIDE POCKETS 14GA	EACH			1.9 #	1.9 #	2		.8 #			
	CORNERS OUTSIDE POCKETS 14GA	20/BOX			38 #	38 #	40		16 #			
	CORNERS OUTSIDE POCKETS 14GA	EACH			1.9 #	1.9 #	2		.8 #			
	CORNERS INSIDE POCKETS 10GA	10/BOX			32 #	32 #	20		8 #			
	CORNERS INSIDE POCKETS 10GA	EACH			3.5 #	3.5 #	2		1 #			
	CORNERS OUTSIDE POCKETS 10GA	10/BOX			32 #	32 #	20		8 #			
	CORNERS OUTSIDE POCKETS 10GA	EACH			3.5 #	3.5 #	2		1 #			
	CORNERS WITHOUT POCKETS 14GA	20/BOX			60 #			J-STAKES ordered separately @ 2 J-Stakes per corner				
	CORNERS WITHOUT POCKETS 14GA	EACH			3 #			J-STAKES ordered separately @ 2 J-Stakes per corner				
	CORNERS WITHOUT POCKETS 10GA	10/BOX			32 #			J-STAKES ordered separately @ 2 J-Stakes per corner				
	CORNERS WITHOUT POCKETS 10GA	EACH			3.5 #			J-STAKES ordered separately @ 2 J-Stakes per corner				
END PIECES												
	END PIECES 14GA	10/BOX			5#							
	END PIECES 14GA	EACH			.5#							
	END PIECES 10GA	10/BOX			7#							
	END PIECES 10GA	EACH			.7#							
	EDGE FORMER	EACH			15#							